

KEY :

- PROPOSED ROAD MARKINGS:
ALL PROPOSED WHITE LINING AND SYMBOLS ARE SHOWN IN BLACK. SOME MARKINGS ARE SHOWN AS BEING LARGER THAN THEY WOULD BE ON SITE
- PEDESTRIAN CROSSING - RED TACTILE PAVING
- PEDESTRIAN CROSSING - UN-CONTROLLED:
TACTILE PAVING, PART OF AN UN-CONTROLLED PEDESTRIAN CROSSING
- AREAS OF FOOTWAY
- PROPOSED CYCLE TRACK
- SHARED SURFACE FOR PEDESTRIANS AND CYCLISTS
- AREAS OF CARRIAGEWAY
- START OF SHARED SPACE OR SEGREGATED FOOTWAY & CYCLEWAY TACTILE PAVING
- SPEED HUMP
- EXISTING PEDESTRIAN CROSSING UPGRADE TO SHARED PEDESTRIAN/CYCLE SIGNAL CONTROLLED CROSSING

DO NOT SCALE

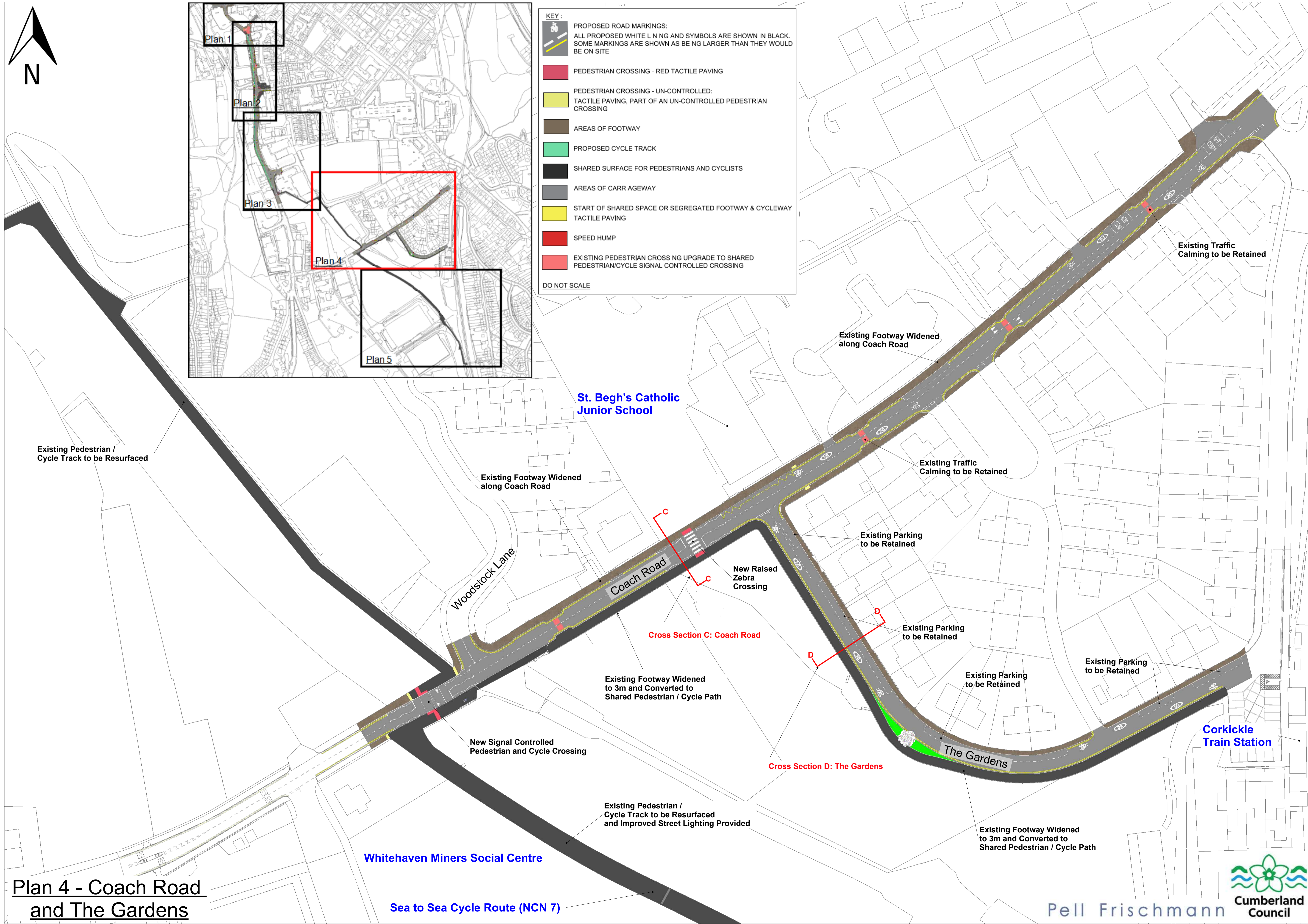

Plan 4 - Coach Road and The Gardens

Whitehaven Miners Social Centre

Sea to Sea Cycle Route (NCN 7)

